

Floor plan

**Second Floor**  
Approx. 66.3 sq. metres (713.5 sq. feet)

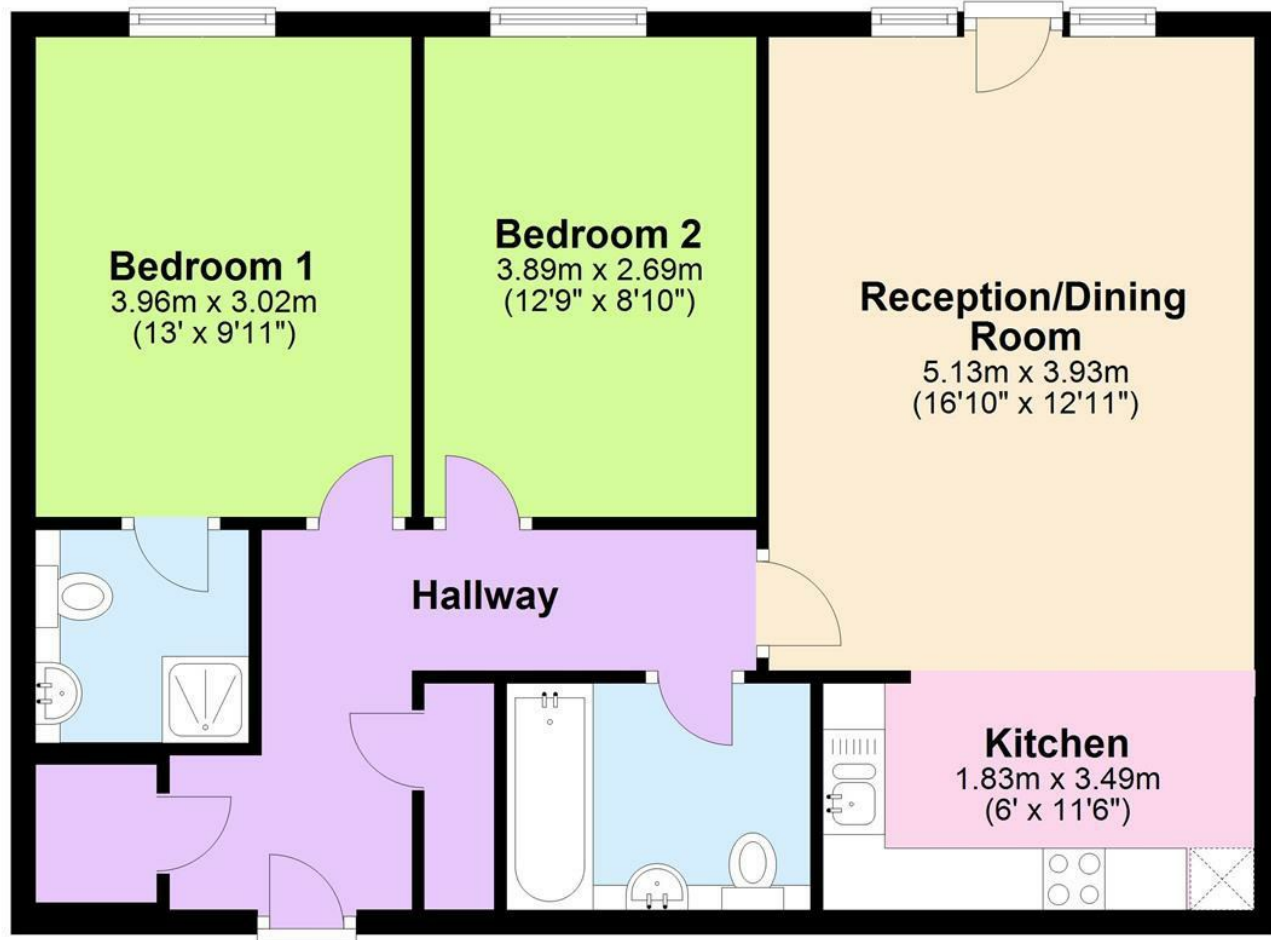

Total area: approx. 66.3 sq. metres (713.5 sq. feet)

Viewing

Please contact our Sterling Kings Langley Office on 01923 27 06 66 if you wish to arrange a viewing appointment for this property or require further information.

Energy performance graph

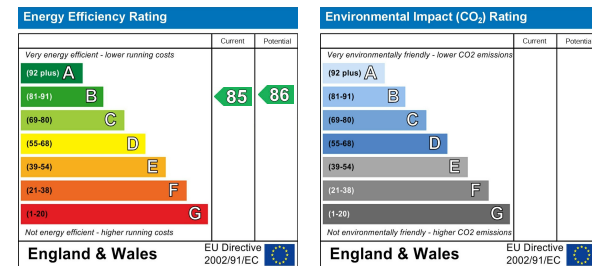

**Kings Langley**



**£1,600 Per Calendar Month**



**Tring**  
 tring@sterlinghomes.co.uk  
 01442 828 222

**Property Management**  
 lettings@sterlinghomes.co.uk  
 01442 822 210

**Kings Langley**  
 kingslangley@sterlinghomes.co.uk  
 01923 270 666

**Berkhamsted**  
 berkhamsted@sterlinghomes.co.uk  
 01442 879 996



www.sterlinghomes.co.uk

# Kings Langley

## £1,600 Per Calendar Month



Sterling Lettings are pleased to offer for let this stunning two double bedroom apartment with allocated parking set over the second floor of the popular Ovaltine Development situated within easy reach of Kings Langley Station. Internally the accommodation comprises entrance hallway, spacious open plan reception/dining room, fitted kitchen with appliances, two well appointed bedrooms, the master with en suite shower room, and separate bathroom with shower. In addition to allocated parking this delightful property also benefits from passenger lift and access to a communal courtyard. Offered Unfurnished & Available Now!

Distance to Stations  
 Kings Langley Station (0.4 Miles)  
 Apsley Station (2.1 Miles)  
 Hemel Hempstead Station (3.8 Miles)  
 Watford Junction Station (4.8 Miles)

Distance to Schools  
 Kings Langley Primary School (1.1 Miles)  
 Kings Langley Secondary School (1.2 Miles)  
 Divine Saviour Roman Catholic Primary School (1.5 Miles)  
 Nash Mills C of E Primary School (1.6 Miles)

Monies Payable  
 There are no administration fees for the preparation of tenancy, the following costs are however applicable:

Holding Deposits - limited to a maximum of 1 week's rent and subject to statutory

legislation on the refund of this payment should the tenancy not go ahead.

Security Deposits - limited to 5 weeks rent as a maximum amount for tenancies where the annual rent is below £50,000, deposits for tenancies where the annual rent is £50,000 or more are limited to the equivalent of 6 weeks rent.

Late Rent Payment - Interest on late rent will be charged at base rate plus 3% on a daily basis from the rent due date - This charge will be levied if a payment is not received in cleared funds by the due date as per the terms of the tenancy agreement. Repayment of interest due will take priority over any rent payments due to avoid outstanding amounts "rolling up"

Tenancy Amendments - £60 Inc VAT - This charge will be levied prior to any amendments (which will be subject to landlord agreement) being made to the standard tenancy agreement.

Agency Reference for new tenancy - £30 Inc Vat Per Tenant - This must be paid every time a request is received in order for us to provide any requested information relating to a previous tenancy with us to any new landlord/agent.

Material Information  
 Rent - £1,600.00 per calendar month

(£369.23 per calendar week)  
 Deposit - £1,846.15  
 Council Tax Band - D (Three Rivers District Council)  
 Pets Considered - Yes

